

REGULATOR, MINI INLINE

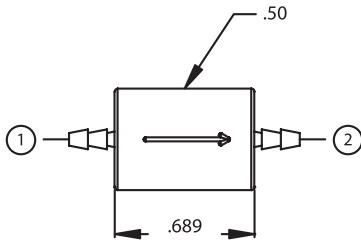

Design Considerations

The Mini Inline Regulator Series promotes a compact design that is Non-Exhausting with 1/16 Barb configuration.



PORT DEFINITIONS
 1. 1/16 Barb Input
 2. 1/16 Barb Output

Specifications

Body: Electroless Nickel Plated Brass

Maximum Operating Pressure – 80 psi
 Maximum Operating Temperature – -25° F to 180° F
 Flow Rate – 1 SCFM @ 50 psi

Example of How to Order

RG 2 NO-B, MINILINE, *
 PSI - (30 Standard), 26-29, 23
 MINI INLINE
 Seal Options – B – Buna, E – Ethylene Propylene (EPDM), F – Fluoroelastomer (Viton®)
 Normally Open
 2-Way (Non-Exhausting)
 Regulator

*** Specify asterisk items only if other than standard