

Part # 201260

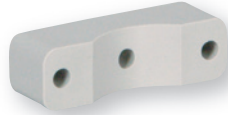

Part # 202085



**RBWO HOLDERS
(Round Back With Step)**

- Part # 201260 HOLDER, RBW, GRAY
- Part # 201270 HOLDER, RBW, BLACK
- Part # 202085 BRKT, SINGLE HOLDER, GRAY
- Part # 202080 BRKT, SINGLE HOLDER, BLACK

Standard SE Holder

- Nylon Construction
- 5/8 Diameter Bell

Part # 203480



**HVE HOLDERS, FB
(Flat Back)**

- Part # 203480 HOLDER, HVE, FB, GRAY
- Part # 203470 HOLDER, HVE, FB, BLACK
- Part # 201156 HOLDER, HVE, FB, GRAY, DRILLED
- Part # 201153 HOLDER, HVE, FB, BLACK, DRILLED

- Nylon Construction
- 7/8 Diameter Bell

Part # 203510



**HVE HOLDERS, RB
(Round Back)**

- Part # 203510 HOLDER, HVE, RB, GRAY, ABS
- Part # 203500 HOLDER, HVE, RB, BLACK, ABS

- Nylon Construction
- Mounting Bracket Available
- 7/8 Diameter Bell

Part # 224190



AUTOHOLDER

- Part # 224190 AUTOHOLDER, STD, GRAY
- Part # 224290 AUTOHOLDER, STD, BLACK
- Part # 224090 AUTOHOLDER, STD, GRAY, W/NCV
- Part # 213090 AUTOHOLDER, STD, BLACK, W/NCV
- Part # 233790 AUTOHOLDER, STD, GRAY, W/NOV
- Part # 270490 AUTOHOLDER, STD, BLACK, W/NOV

- Nylon Construction
- W/Valve Holders Includes Two 10-32 Mounting Screws
- 5/8 Diameter Bell