

SHUTTLE VALVE

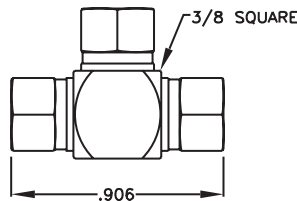
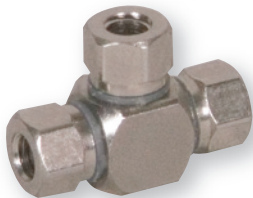
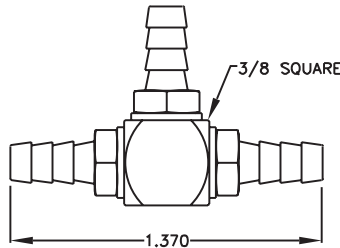
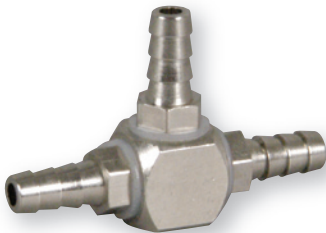
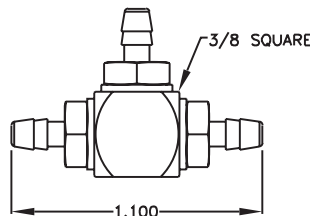
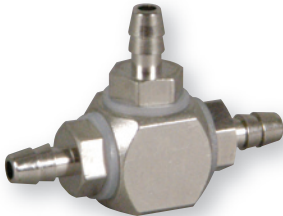
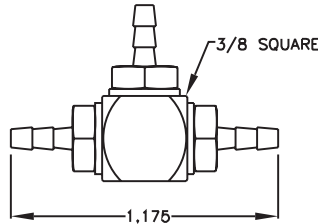
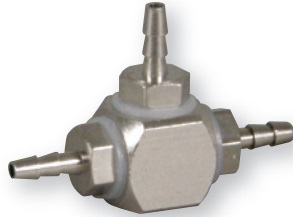

Design Considerations

The Shuttle Valve Series promotes a compact design with multiple end configurations to fit the exact end use application. The Shuttle Valves incorporate a double O-ring guided piston to provide a positive seal at approximately 1/2 psi pressure differential between the Side Inlet Ports. The Shuttle Valves are Electroless Nickel Plated Brass inside and out.

Specifications

Body: Electroless Nickel Plated Brass

Maximum Operating Pressure – 1 - 125 psi
 Maximum Operating Temperature – -25°F to 180°F
 CV – Approximately .05

Example of How to Order

SV B 1/16B

Barb – 1/16 Barb, 3/32 Barb, 1/8 Barb, 10-32M, 10-32F

Seal Options – Buna-N, E - Ethylene Propylene (EPDM), F - Fluoroelastomer (Viton®)

SV – Shuttle Valve

*** Specify asterisk items only if other than standard